

design matters



JUNE 22, 2016

Campbellsport

SCHOOL DISTRICT





Agenda

■ Old Business

- Community Buzz
- FAQs

■ New Business

- Priorities – Paul
- Finance Update – Topher
- Schematics and Budgeting – Somerville / CD Smith

■ Next Meetings

- **Community Meeting** - Monday, June 27, 2016
MS-HS Media Center at 6:30 p.m.
- **Core Action Team** - TBD



Priorities:

- **1936 (1951, 1956 portions) Building (replace/relocate lost spaces)**
 - Instructional Spaces (7 active classrooms, 2 therapy/life skills space)
 - Gym Space and related areas (assumed to be a competition space)
 - Pupil Services/Middle School Offices
- **Safety and Security of Building Issues**
 - Traffic Flow
 - Main Entrance
- **Address Other Curriculum Needs**
 - Tech Ed (STEM) proximity, needs and growth
 - Music space proximity and functional demands
 - Redesign affected spaces with flexibility and efficiency in mind



Issues of less importance:

- Cafeteria Needs Updating
- Science room size
- FACE space addressed

Finance Update:

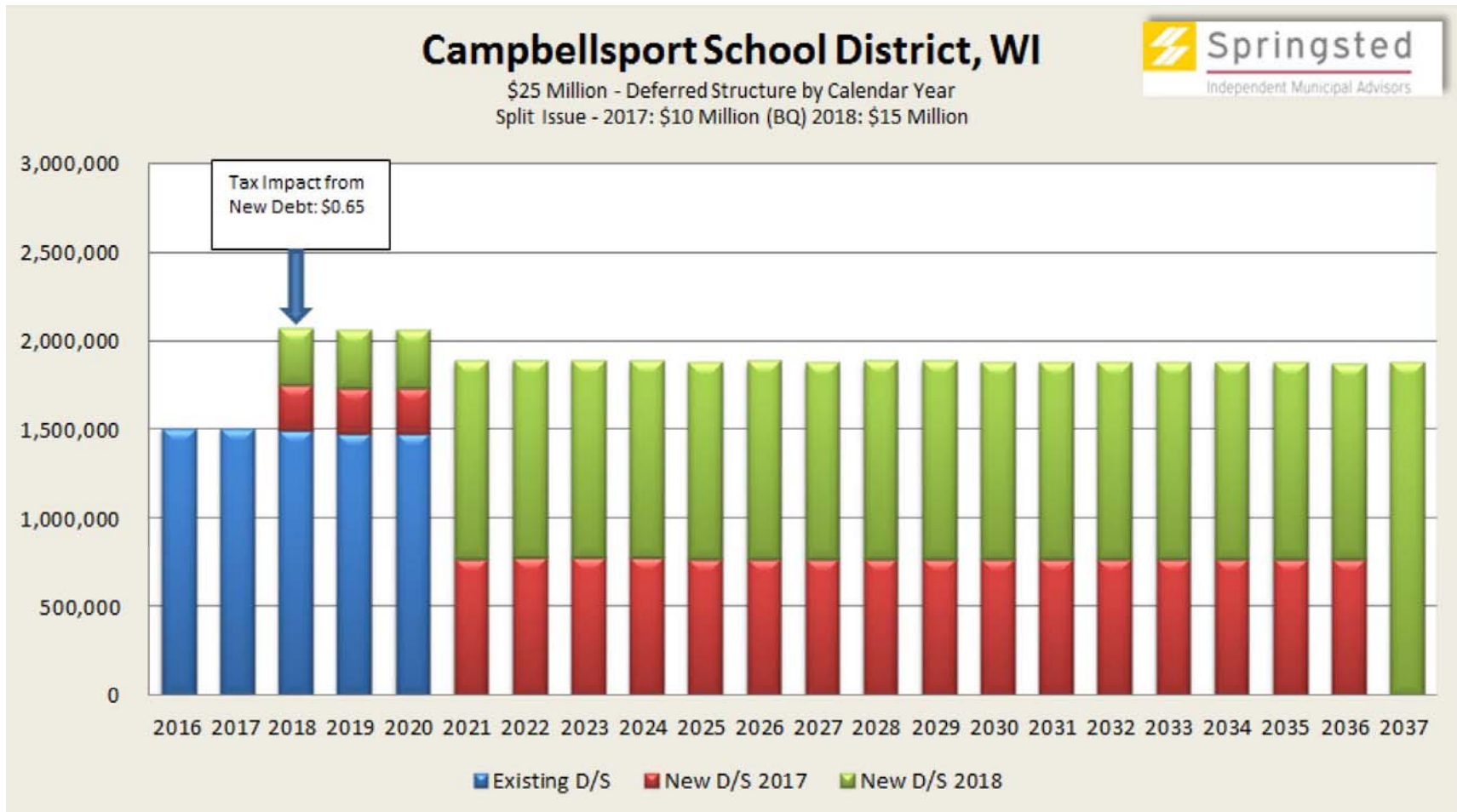



New 6-12 School

- Based on 280,000 SF
- Cost Range \$60,000,000 - \$65,000,000



New Middle School Addition



- Based on 170,000 SF
- Cost Range \$38,000,000 - \$43,000,000

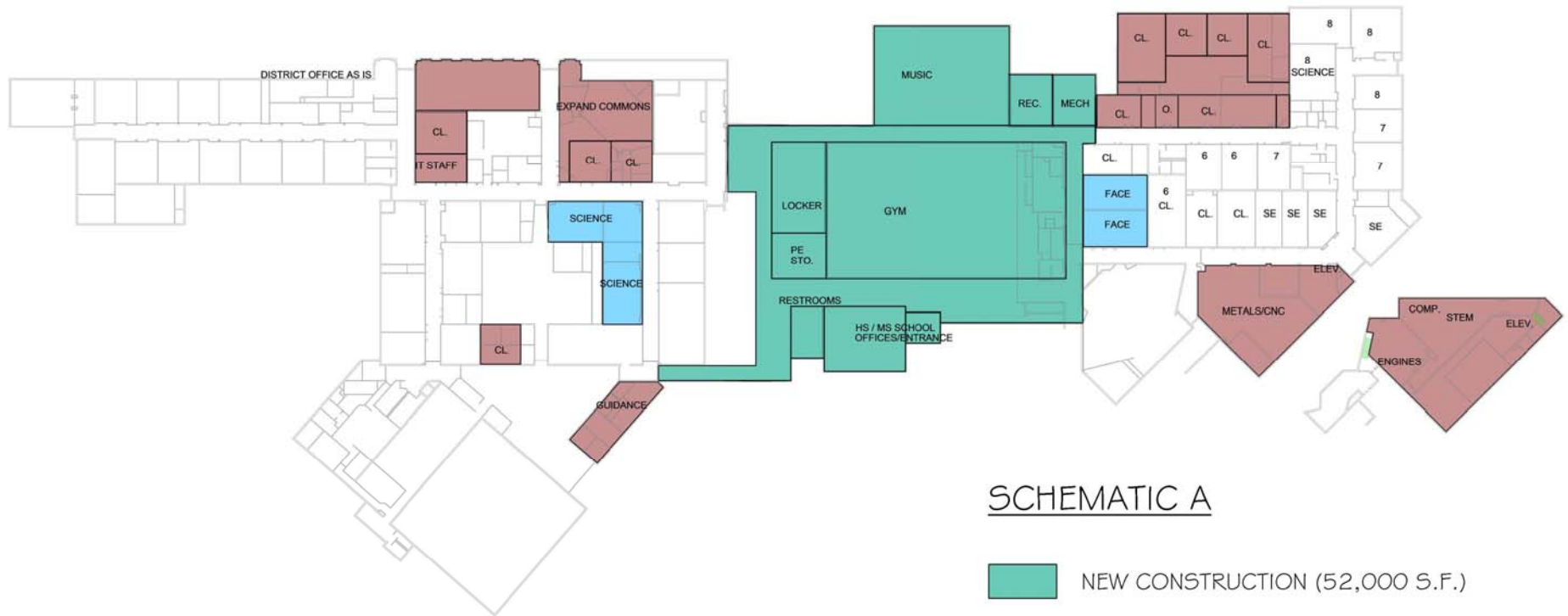

Schematic A



SCHEMATIC A

-  NEW CONSTRUCTION (52,000 S.F.)
-  REMODEL (40,100 S.F.)
-  REMODEL (6,400 S.F.)

NOTE: PLUS MAINTENANCE BUILDING



Schematic A

■ New Addition 52,000 SF

- 3-Station Gym, Locker Room, Music, Office

■ Major Renovation

- MS Offices, STEM (existing and in lower level), Science, Office, Cafeteria, FACE, existing STEM

■ Existing Spaces

- Allowance for Mechanical upgrades

■ Maintenance Building

■ Site Work

■ Contingency

■ Soft Costs

- Asbestos Abatement (allowance), FF&E, Land Acquisition, IT Requirements/Technology, A/E Fees, Reimbursables/Permits

■ Cost Range



\$23,500,000 - \$24,500,000

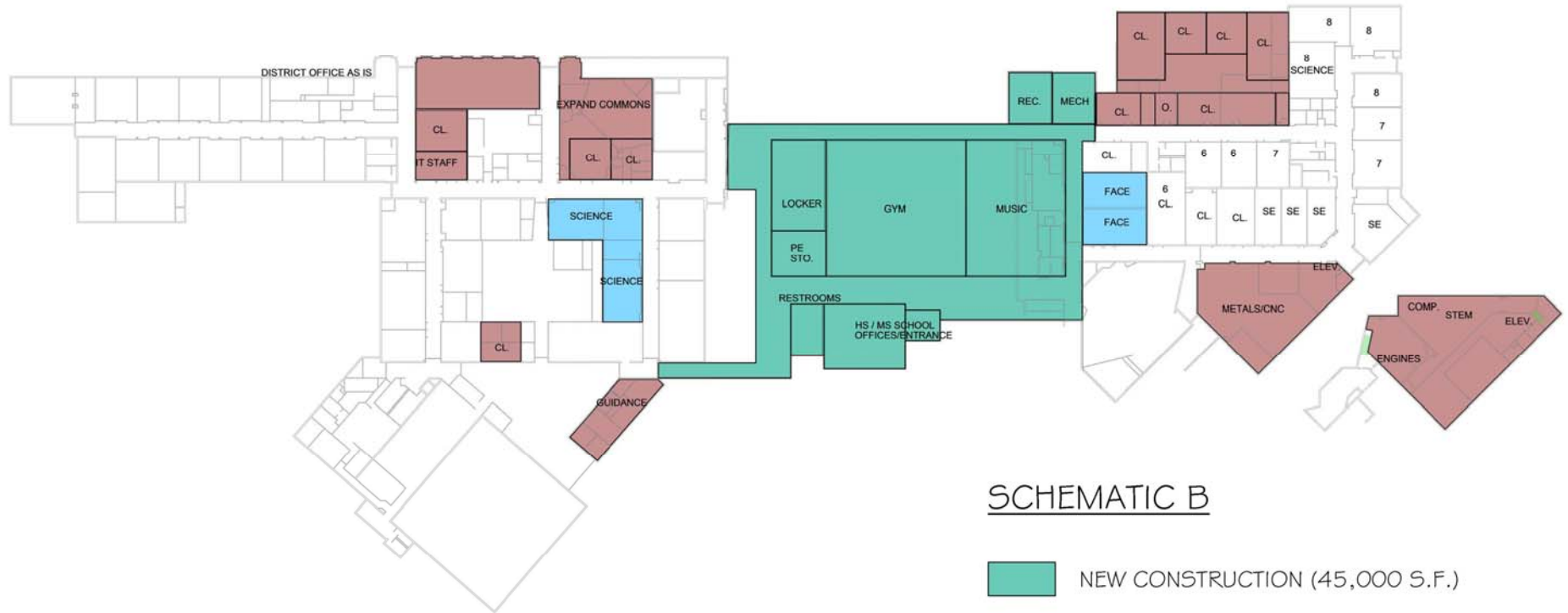

Schematic B



SCHEMATIC B

-  NEW CONSTRUCTION (45,000 S.F.)
-  REMODEL (40,100 S.F.)
-  REMODEL (6,400 S.F.)

NOTE: PLUS MAINTENANCE BUILDING



Schematic B



- **New Addition 45,000 SF**
 - 2-Station Gym, Locker Room, Music, Office
- **Major Renovation**
 - MS Offices, STEM (existing and in lower level), Science, Office, Cafeteria, FACE, Existing STEM
- **Existing Spaces**
 - Allowance for Mechanical upgrades
- **Maintenance Building**
- **Site Work**
- **Contingency**
- **Soft Costs**
 - Asbestos Abatement (allowance), FF&E, Land Acquisition, IT Requirements/Technology, A/E fees, Reimbursables/Permits
- **Cost Range**
\$22,000,000 - \$23,000,000



Schematic C



SCHEMATIC C

-  NEW CONSTRUCTION (58,000 S.F.)
-  REMODEL (25,400 S.F.)
-  REMODEL (11,200 S.F.)



Schematic C

■ New Addition 58,000 SF

- 2-Station Gym, Locker room, Tech, Office

■ Major Renovation

- MS Offices, Science, HS Office, Cafeteria, FACE, Classrooms, Existing Tech becomes Theater Acc. & Maintenance

■ Existing Spaces

- Allowance for Mechanical upgrades

■ Site Work

■ Contingency

■ Soft Costs

- Asbestos Abatement (allowance), FF&E, Land Acquisition, IT Requirements/Technology, A/E fees, Reimbursables/Permits

■ Cost Range



\$23,000,000 - \$24,000,000



Schematic D



SCHEMATIC D

-  NEW CONSTRUCTION (58,000 S.F.)
-  REMODEL (38,500 S.F.)
-  REMODEL (3,900 S.F.)



Schematic D

■ New Addition 58,000 SF

- 3-Station Gym, Locker room, Tech, Office

■ Major Renovation

- MS Offices, Science, HS Office, Cafeteria, FACE, Classrooms, Existing Tech becomes Choir & Band

■ Existing Spaces

- Allowance for Mechanical upgrades

■ Site Work

■ Contingency

■ Soft Costs

- Asbestos Abatement (allowance), FF&E, Land Acquisition, IT Requirements/Technology, A/E fees, Reimbursables/Permits

■ Cost Range

\$24,000,000 - \$25,000,000

design matters



Questions?